

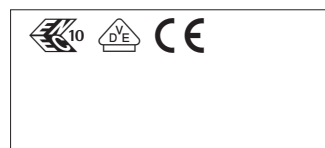

78361.000 Black
Length 1000mm

Product description

Aluminium profile, powder-coated.
Mounting surface with easy to remove knockouts at 0.4m interval.
4 isolated copper conductors and pressed-in earth conductor.
When used as DALI track: one 16A circuit and two conductors for connecting to the DALI data line.
When used as a 3-circuit track: three separately switchable circuits 16A each.
The ERCO track system is approved to IEC 60570 (EN 60570/VDE 0711 part 300).
Weight 1.10kg

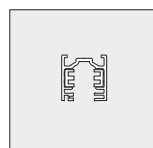
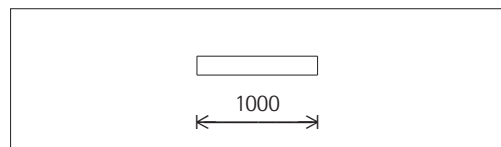
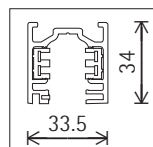

Technical data based on international standards and directives

IEC 60598	Luminaires – Parts 1+2: General requirements, particular requirements and tests
IEC 62031	LED modules for general lighting – Safety specifications
IEC 62471	Photobiological safety of lamps and lamp systems
EN13032-4	Light and lighting – Measurement and presentation of photometric data of lamps and luminaires
CIE 13	Method of measuring and specifying colour rendering of light sources

Accessories



79320.000
3-circuit live end
Polymer.
Earth conductor, right.
Black

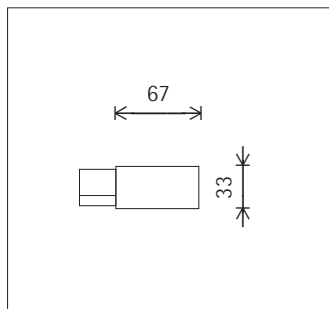

79324.000
3-circuit coupler
Polymer.
Feeding possible. Through-wiring.
Black

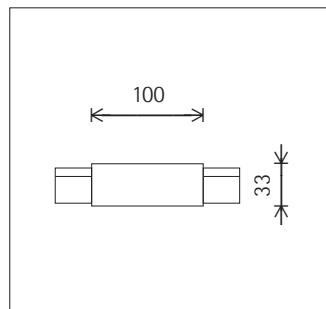

79321.000
3-circuit live end
Polymer.
Earth conductor, left.
Black

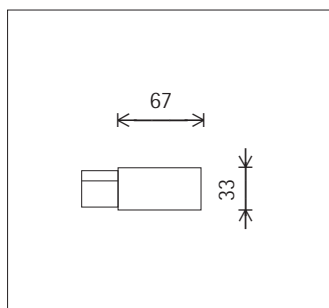

79326.000
3-circuit L-connector
Polymer.
Earth conductor inside. Feeding possible. Through-wiring.
Black

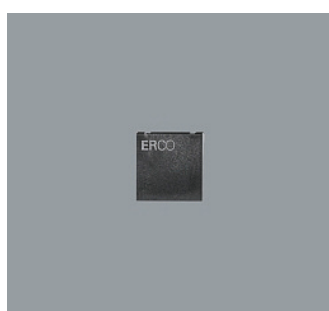
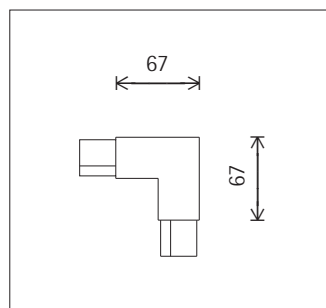

79322.000
End plate
Polymer.
Black

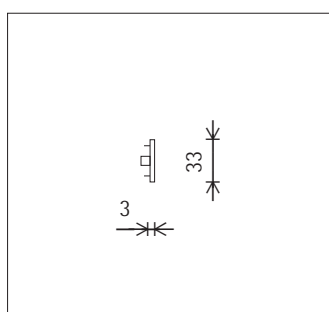

79327.000
3-circuit L-connector
Polymer.
Earth conductor outside. Feeding possible. Through-wiring.
Black

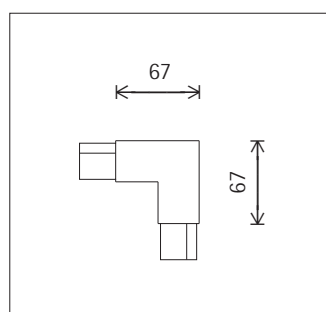

Accessories

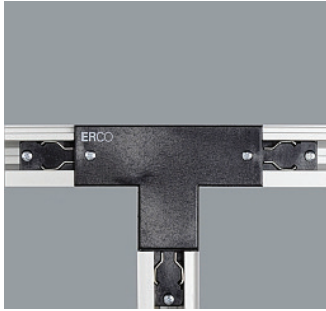

79328.000
3-circuit T-connector
Polymer.
Earth conductor, right. Feeding possible.
Through-wiring.
Black
🔌 ⚡ CE

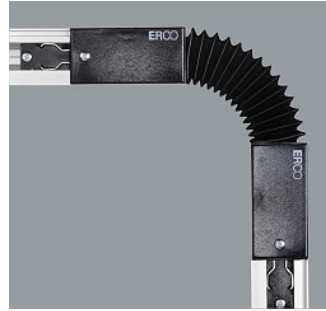
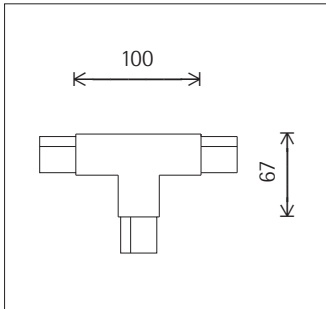

79331.000
3-circuit Multiflex coupler
Polymer.
Feeding possible. Through-wiring.
Black
🔌 ⚡ CE

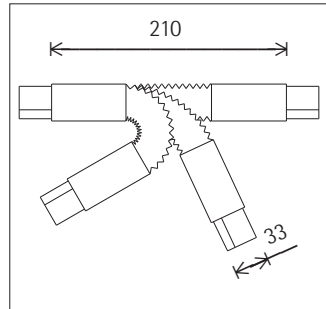

79329.000
3-circuit T-connector
Polymer.
Earth conductor, left. Feeding possible.
Through-wiring.
Black
🔌 ⚡ CE

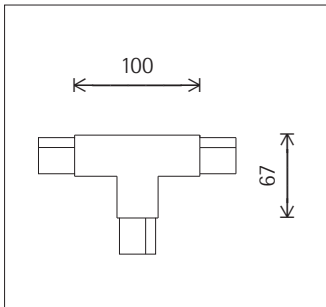

79335.000
Coupler
for flush connection of ERCO track.
Polymer.
Black
🔌 ⚡ CE

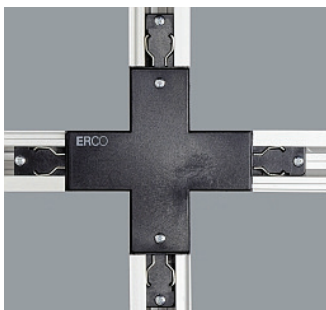
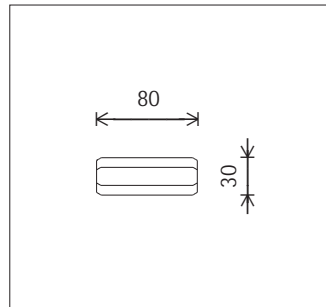

79330.000
3-circuit X-connector
Polymer.
Feeding possible. Through-wiring.
Black
🔌 ⚡ CE

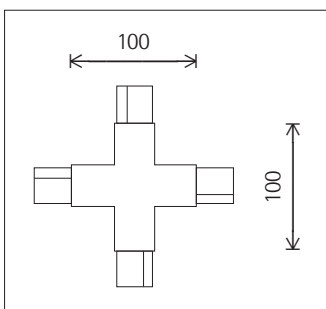

79052.000
ERCO 3-circuit adapter
with earthed coupler. 250V, 6A.
Spiral cable 3x0,75mm².
L 700/1400mm.
Black



79024.000
ERCO 3-circuit adapter
with earthed socket outlet. 250V, 10A.
Polymer. Cover: Polymer, black.
L 71mm, B 56mm, H 90mm.
Black
CE

Accessories



79030.000
ERCO 3-circuit adapter
Installation kit for 250V, 10A pendant luminaire, with strain relief. Polymer. Connection cable 3 x 0.75mm², L 1500mm. Load: 3.30kg. Individual parts to be assembled on-site. Black. Weight 0.15kg



79221.000
DALI live end
Polymer.
Earth conductor, left.
Black
CE



79054.000
ERCO 3-circuit adapter
for pendant luminaire, 250V, 10A, with hook and terminal block. Polymer. Load: 10kg. L 71mm, B 32mm, H 33mm. Black

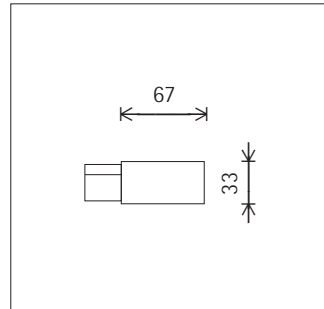

12690.000
Spiral cable
L 500/2,500mm.
Black 3x1.5mm²
CE



79224.000
DALI coupler
Polymer.
Feeding possible. Through-wiring.
Black
CE



12691.000
Spiral cable
L 500/2,500mm.
Black 5x1.5mm²
CE

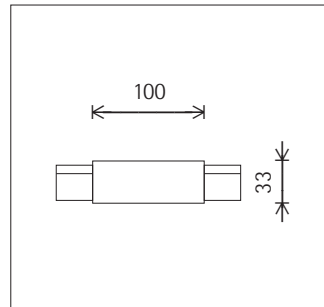

79220.000
DALI live end
Polymer.
Earth conductor, right.
Black
CE



79226.000
DALI L-connector
Polymer.
Earth conductor inside. Feeding possible. Through-wiring.
Black
CE

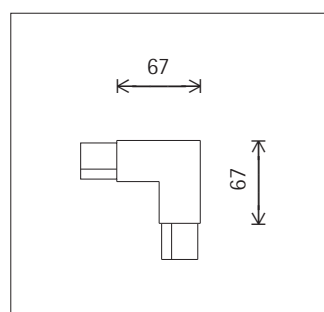
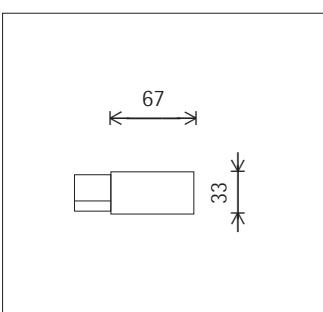

Accessories



79227.000
DALI L-connector
Polymer.
Earth conductor outside. Feeding possible. Through-wiring.
Black
CE

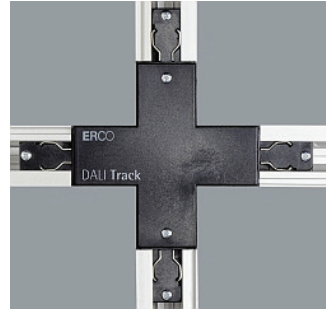
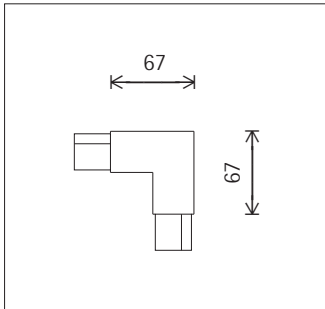

79230.000
DALI X-connector
Polymer.
Feeding possible. Through-wiring.
Black
CE

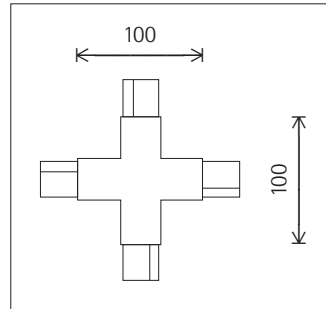

79228.000
DALI T-connector
Polymer.
Earth conductor, right. Feeding possible. Through-wiring.
Black
CE

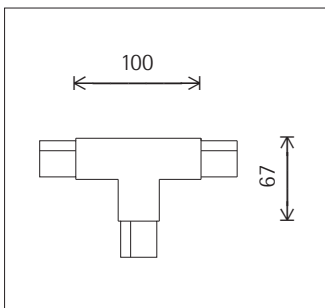

79231.000
DALI Multiflex coupler
Polymer.
Feeding possible. Through-wiring.
Black
CE

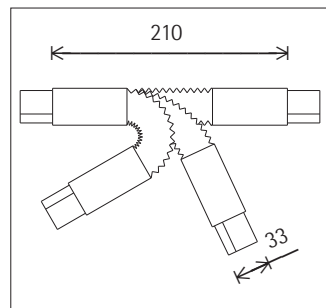

79229.000
DALI T-connector
Polymer.
Earth conductor, left. Feeding possible. Through-wiring.
Black
CE

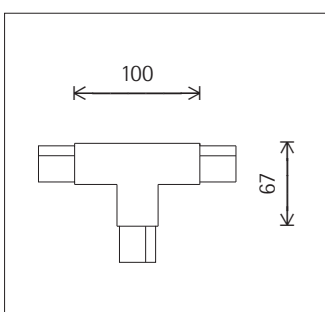

79048.000
ERCO DALI adapter
for 250V, 1A pendant luminaire, with strain relief. Polymer.
Connection cable 5x0,75mm², L 1500mm.
Requirements placed on DALI control gear: DALI input suitable for mains voltage, max. capacity 750pF.
Not suitable for DALI singlet.
Black
Weight 0.39kg
CE

Accessories



79550.000
Mounting device
for suspension on live end.
Metal.
Black
Only in conjunction with
79220.000
79221.000
79320.000
79321.000

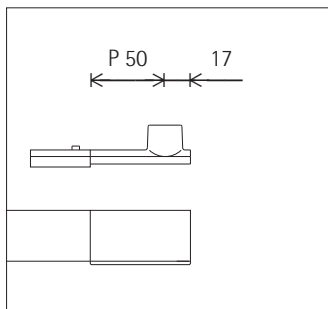

79565.000
Mounting device
for suspension on T-connector.
Metal.
Black
Only in conjunction with
79228.000
79229.000
79328.000
79329.000

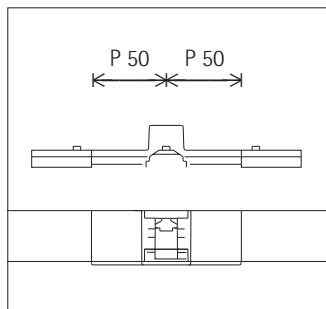

79555.000
Mounting device
for suspension on coupler with feed-
ing.
Metal.
Black
Only in conjunction with
79224.000
79324.000

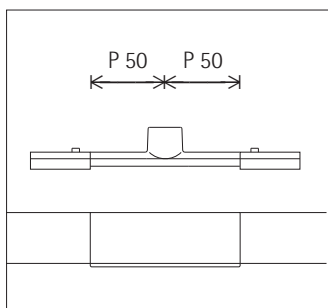

79570.000
Mounting device
for suspension on X-connector.
Metal.
Black
Only in conjunction with
79230.000
79330.000

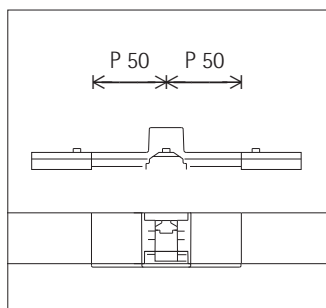

79560.000
Mounting device
for suspension on L-connector.
Metal.
Black
Only in conjunction with
79226.000
79227.000
79326.000
79327.000

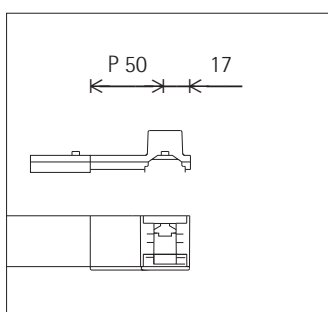

78670.000
Mounting device
for suspension on track.
Metal.
Black



78651.000
Mounting device
for subsequent mounting on track.
Black
Only in conjunction with
12440.000

Accessories



12440.000
Wire rope
Load: 20kg.
ø 1.75mm, L 10m.



78633.000
Mounting toggle
for fixing track in plaster trim profiles.
Only in conjunction with
78350.000



16910.000
Turnbuckle with 2 clamps
Metal, galvanised.
Load: 60kg.
Only in conjunction with
12440.000

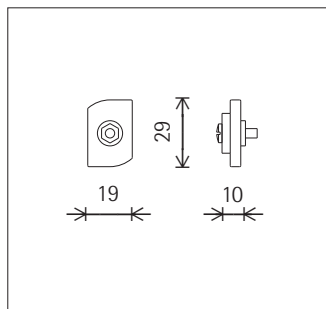

78350.000
Plaster trim profile
Aluminium profile, silver anodised. For
flush mounting of track in plasterboard
ceilings.
B 40mm, H 52mm, L 3000mm.
Weight 3.00kg



79500.000
Suspension device for track
Metal, galvanised.
Subsequent mounting of suspension
bridge in ERCO track possible.
Load: 15kg.
L 30mm, H 47mm.

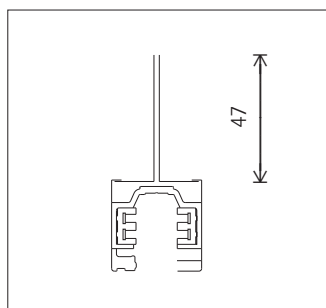
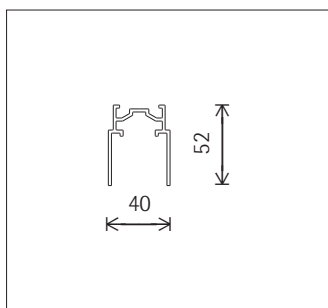

79515.000
Mechanical bridge
for connection of plaster trim profiles.
Only in conjunction with
78350.000



79501.000
Suspension bridge
for direct track coupler connection.
Metal, galvanised.
Subsequent mounting of suspension
bridge in ERCO track possible.
Load: 20kg.
L 180mm, H 47mm.

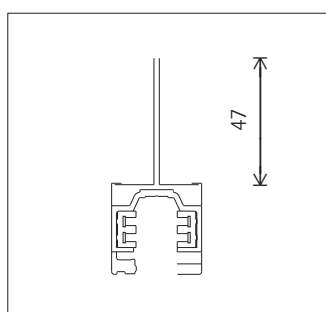
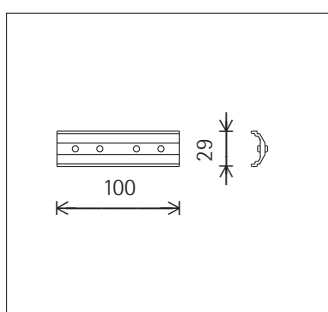

Accessories



79503.000
Fixing clip
Spring steel, galvanised.
Load: 20kg.
L 33mm.
14mm.

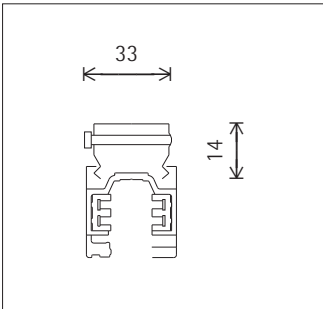

79504.000
Junction
with two screws.
Aluminium, anodised.
Load 30kg.
L 50mm, H 26mm.

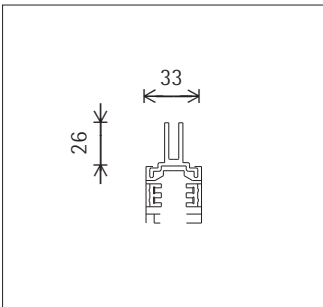

79530.000
Mounting device
for M5 screws, with retaining spring.
Cast aluminium.
Load: 10kg.

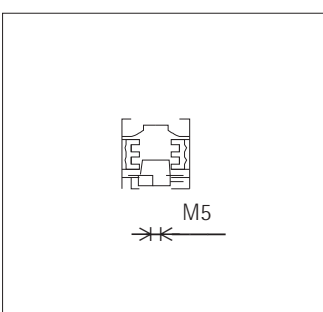

79527.000
Display hook
Polymer/steel.
Load: 10kg.
L 67mm.



79528.000
Mounting device
with M4 set screw and two nuts. Poly-
mer/steel.
Load: 10kg.
L 55mm.



79547.000
Cover profile
Polymer.
L 10m.
Black



79549.000
Cable nippers
for shortening the copper conductors in
track.



12445.000
Pendant tube suspension
Pendant tube: metal, powder-coated.
ø 13mm, L 1,040mm.
Baldachin: polymer. ø 64mm, H 73mm.
Load: 20kg.
Black
CE
Only in conjunction with
78670.000
79550.000
79555.000
79560.000
79565.000
79570.000

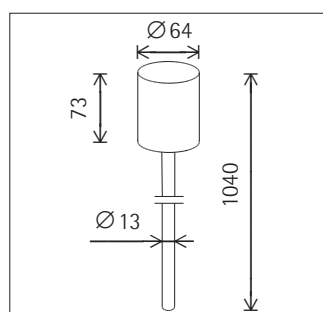

Accessories



12671.000
Wire rope suspension
Wire rope: \varnothing 1.50mm, L 2,500mm.
Mounting bush: metal.
Canopy: polymer, white, \varnothing 105mm, H 43mm.
Cable entry for 5x1.5mm² polymer-coated cable or spiral cable.
Strain relief. Terminal block.
Load: 20kg.

CE
Only in conjunction with
78670.000
79550.000
79555.000
79560.000
79565.000
79570.000

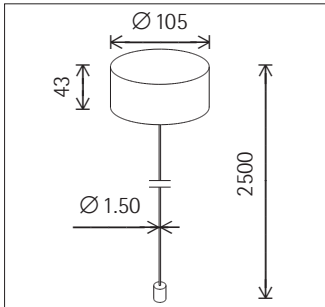

12557.000
Wire rope suspension
With single-point fixing and rapid connector for adjustment levelling.
Wire rope: \varnothing 1.50mm, L 2,500mm.
Ceiling fixture: cast aluminium/metal, white powder-coated. \varnothing 18mm, H 49mm.
Load 20kg (with heavy load dowel).
Only in conjunction with
78670.000
79550.000
79555.000
79560.000
79565.000
79570.000

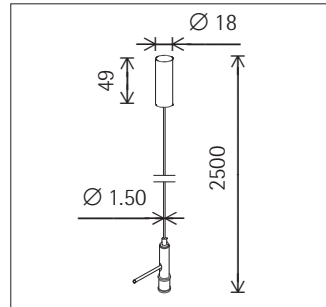

12662.000
Wire rope suspension
Wire rope: \varnothing 1.50mm, L 2,500mm.
Mounting bush: metal.
Canopy: polymer, white, \varnothing 65mm, H 63mm.
Cable entry for 3x1.5mm² polymer-coated cable or spiral cable.
Strain relief. Terminal block.
Load: 20kg.

CE
Only in conjunction with
78670.000
79550.000
79555.000
79560.000
79565.000
79570.000

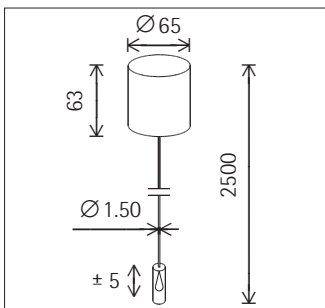

12560.000
Wire rope suspension
With rapid connector for adjustment levelling.
Wire rope: \varnothing 1.50mm, L 2,500mm.
Ceiling fixture: cast aluminium/metal, powder-coated. \varnothing 65mm, H 14mm.
Load: 20kg.

Black
Only in conjunction with
78670.000
79550.000
79555.000
79560.000
79565.000
79570.000

